

Strip saw for parquet flooring PS 160

for parquet glued with elastic adhesive (solid wood, 2 and 3 layers)

www.frueh-maschinen.de

ALMOST
DUST
FREE

Technical data

Voltage	230 V
Power	1.5 kW
Speed	7500 rpm
Ø blade	160 mm
Weight	18 kg
Suction nozzle	Ø 38 mm
Max. cutting depth	20 mm



- Saw blade with extremely high tool life (approx. 50 times longer than carbide)
- No need to draw guidelines prior to sawing
- Upright, ergonomic working posture
- Work almost dust-free
- Simple, compact operating unit
- High safety standards

(dead man's switch, safety lock for dipped blade, strain relief)

This saw is the indispensable, perfect partner for the **chisel stripper, MSK 900**, when removing parquet flooring which has been glued with 1C-PU or 1 C-SMP adhesives. Parquet surfaces are cut into 150 mm wide strips in no time thanks to the PS 160 and its parallel guide on both sides – and without any laborious preparation!

Thanks to the special PCD blade and the infinitely adjustable cutting depth, it is possible to cut through the whole layer of parquet right through to the adhesive. Even if the blade cuts into the upper mineral layer of sub-flooring (filler, screed, etc.) every now and again, this will have little effect on the blade's tool life.

The multi-functional shafted handle is three-dimensionally adjustable and, as a result, can be adapted to cope with any given conditions. The machine is guided, the motor switched on, the saw lowered into position and the safety lock for the dipped blade activated via the shafted handle.



Detailed description of the strip saw for parquet flooring PS 160

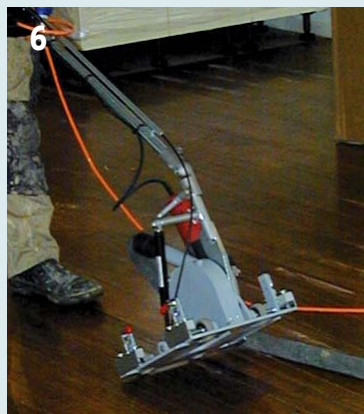
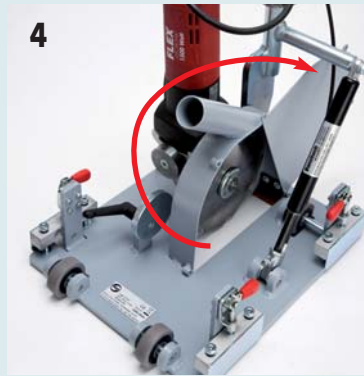

1. The depth of the saw is infinitely adjustable thanks to the adjustable clamp lever and the eccentric limit stop.

2. Parallel guides

a) in the raised position they serve as the wall contact for the first cut

b) if both toggle levers are turned 180° the ruled guide rails can be lowered into the previous incision so that the next cut will be exactly parallel to the one before.

3. Details on the multi-functional shafted handle – all within easy reach:

- safety lock and engaging lever (dead man's switch)
- button for controlling the gas pressure spring when lowering and raising the saw blade.
- cable strain relief

4. The lid on the dust extraction hood which is integrated into the chassis is folded back in order to mount the saw blade.

5. Special PCD blade

6. To manoeuvre the machine, simply tip it back until it is resting on the rear wheels

Scope of delivery:

Saw with 1 PCD blade incl. cable – 15 m, saw depth adjustment and parallel guides

Technical data are subject to change.
Printed in Germany 06/2012

→ +49 7181 929732



Erwin Früh GmbH

Machines and accessories for professional floor treatment and sub-floor preparation

Vorstadtstrasse 61 - 67, D-73614 Schorndorf
Fon +49 7181 92 97 32, Fax +49 7181 92 97 33

info@frueh-maschinen.de
www.frueh-maschinen.de